

~GENERAL PLAT NOTES~

1. THE PROPERTY SHOWN HEREON IS SUBJECT TO ANY AND ALL LEGAL EASEMENTS AND RIGHT OF WAYS, RECORDED AND UNRECORDED, INCLUDING BUT NOT LIMITED TO THOSE SHOWN HEREON. THE PROPERTY SHOWN HEREON IS ALSO SUBJECT TO ANY PLAT RESTRICTIONS AND PLANNING AND ZONING REGULATIONS THAT MAY APPLY.
2. THIS SURVEY WAS PERFORMED AT THE DIRECTION OF THE CLIENT WITHOUT THE BENEFIT OF A TITLE SEARCH. THIS SURVEY IS SUBJECT TO ANY AND ALL FACTS THAT MAY BE DISCLOSED BY A FULL AND ACCURATE TITLE SEARCH. NO ATTEMPT WAS MADE BY THE SURVEYOR TO RESEARCH THE TITLE OTHER THAN THAT WHICH IS NECESSARY FOR THE ESTABLISHMENT OF THE BOUNDARY BY THE MINIMUM STANDARDS OF THE STATE OF KENTUCKY AS NOTED IN THE SURVEYORS CERTIFICATE.
3. THIS BOUNDARY SURVEY DOES NOT DETERMINE LAND OWNERSHIP. A PROFESSIONAL LAND SURVEYOR ONLY PROVIDES AN OPINION OF PREVIOUSLY DESCRIBED PROPERTY LINES WHICH MAY OR MAY NOT BE UPHOLD BY A COURT OF LAW. UNWRITTEN RIGHTS MAY OR MAY NOT EXIST ON THE SUBJECT PROPERTY.
4. ADJOINING OWNERS ARE SHOWN PER TAX RECORDS.
5. THIS SURVEY IS SUBJECT TO ANY PLANNING & ZONING REGULATIONS THAT MAY APPLY.
6. FIELD WORK WAS COMPLETED ON MAY 25TH, 2023

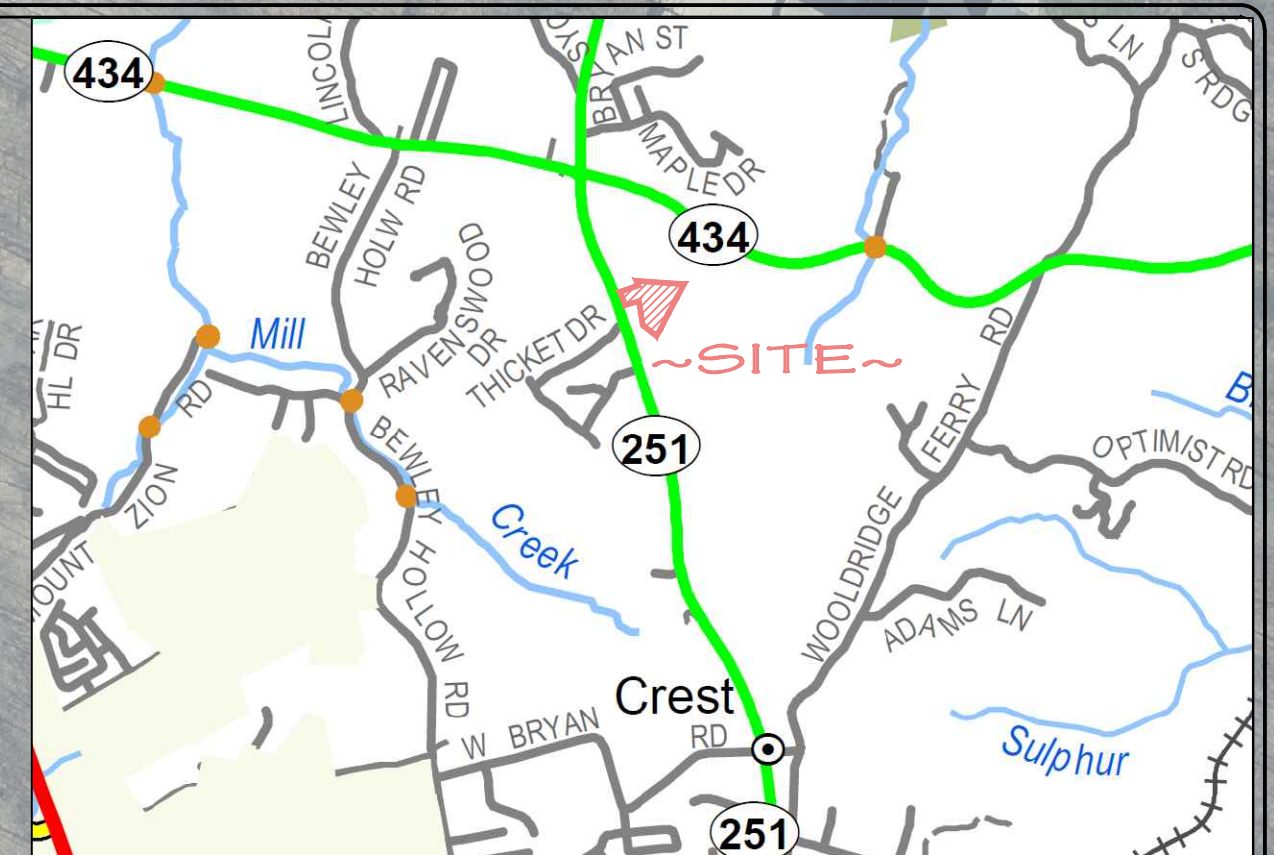

~VICINITY MAP~
NOT TO SCALE



PLAT LEGEND

- 1/2" X 24" STEEL REBAR SET WITH A YELLOW ID CAP STAMPED "J. LYNCH PLS 3953"
- 1/2" REBAR WITH ID CAP "D CLEMONS PLS 3383" UNLESS OTHERWISE NOTED
- E—E— C/L OF 30' OVERHEAD ELECTRIC ESMT.
- ⊙ POWER POLES
- BOUNDARY LINES

BOUNDARY SURVEY OF:

GLENN & JENNIFER WHYTE PROPERTY

SHEPHERDSVILLE ROAD, ELIZABETHTOWN, HARDIN CO., KENTUCKY

OWNER/CLIENT: GLENN & JENNIFER WHYTE
400 RED BUD DRIVE
ELIZABETHTOWN, KY. 42701

SCALE: 1 IN. = 80 FT.	DWG. BY: J. LYNCH PLS	PWA #: 217-00-00-043
DATE: 05/25/23	AREA: 11.510 ACRES	DWG. NAME: C:\DRAWINGS\HARDIN\ (SHEPHERDSVILLE ROAD) WHYTE
BILL #: 23-107	SOURCE: DB 1372 PG 1590	

Lynch Land Surveying
(270) 401-8140 ~ jlynch3953@hotmail.com
3049 LILAC ROAD, LEITCHFIELD, KENTUCKY 42754

THIS PLAT REPRESENTS A BOUNDARY SURVEY AND COMPLIES WITH 201 KAR 18:150.

~SURVEYORS CERTIFICATION~

I HEREBY CERTIFY THAT THE SURVEY DEPICTED BY THIS PLAT WAS DONE BY PERSONS UNDER MY DIRECT SUPERVISION BY THE METHOD OF "RTK". GPS EQUIPMENT OR BY RANDOM TRAVERSE. 100% OF THIS SURVEY WAS PERFORMED USING DUAL FREQUENCY JAVAD LS+ & T3 BASE GPS EQUIPMENT, WITH THE REMAINDER USING A TOPCON PT103A ROBOTIC TOTAL STATION. THIS SURVEY IS AN URBAN SURVEY AND MEETS ALL THE ACCURACY & PRECISION SPECIFICATIONS OF THIS CLASS AND/OR THE RELATIVE POSITIONAL ACCURACY OF EACH POINT IS (±0.03' + 100PPM). THE ANGULAR & LINEAR MEASUREMENTS HAVE NOT BEEN ADJUSTED FOR CLOSURE AND ARE CORRECT TO THE BEST OF MY KNOWLEDGE AND BELIEF. I ALSO CERTIFY THAT ALL MONUMENTS INDICATED HERE DO ACTUALLY EXIST AND THAT THEIR LOCATIONS, SIZES, AND MATERIALS ARE CORRECTLY INDICATED.
HORIZONTAL DATUM—NAD'83, VERTICAL DATUM—NAVD'88, GEOID MODEL—GEOID '18; KENTUCKY SINGLE ZONE; US SURVEY FEET

DATE OF SIGNATURE: JEREMY L. LYNCH, LICENSED PROFESSIONAL LAND SURVEYOR #3953

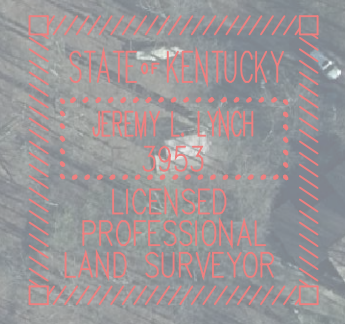

05/25/23
DATE OF FIELD SURVEY

